

INTERIOR PARTS

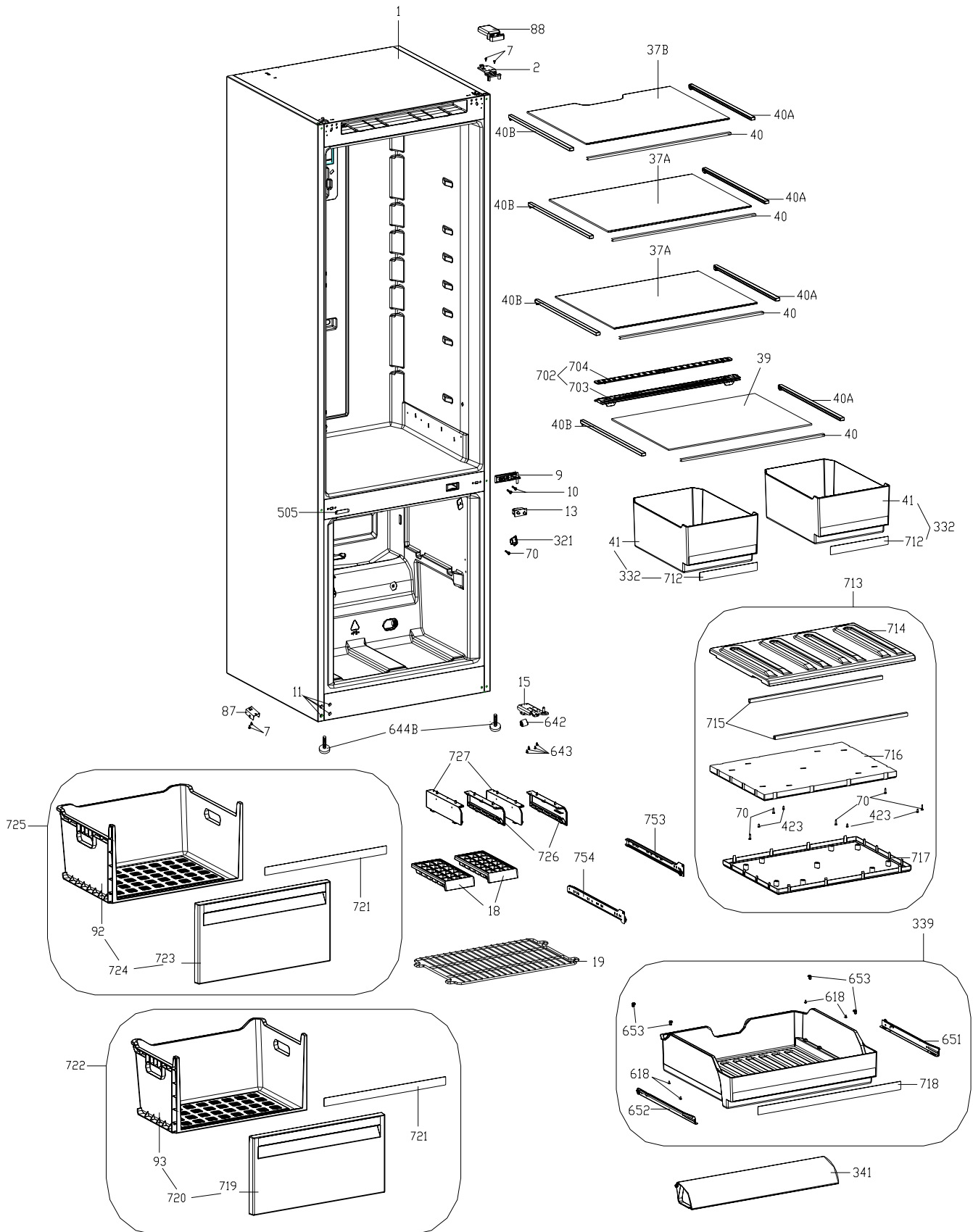



WHITE GOODS

NO-FROST COMBI 566 MECHANIC

INTERIOR PARTS LIST

**CUSTOMER
SUPPORT**

POSITION NUMBER	PART NAME	POSITION NUMBER	PART NAME
1	ASSY URT CAB/566M	618	SCREW 30*8 YSB-F-INOX
2	TOP HINGE/HC GR. (METAL SHEET)RIGHT	642	FRONT WHEEL 566 GR.
7	SCREW M5*14 YSB-F	643	SCREW TT M5x25 YSB-F
9	MIDDLE HINGE GR	644B	STATIONARY FOOT M8/566
10	SCREW TT M5*14 YSB-R-F	651	CHILLER RAIL INTERNAL (RIGHT)/566
11	MIDDLE HINGE SREW CAP(SMALL)	652	CHILLER RAIL INTERNAL (LEFT)/566
13	MIDDLE BRACKET SWITCH GR.	653	SCREWS M4*15 YSB-F
15	BOTTOM HINGE/HC 566 GR.	702	CRISPER COVER TRIM GR./566
18	ICE TRAY/566	703	CRISPER COVER TRIM/566
19	F SHELF/566	704	CRISPER COVER TRIM VALVE/566
37A	R GLASS SHELF/566	712	ACCESSORY FILM/CRISPER
37B	R GLASS SHELF/566 MEC.	713	CRISPER-CHILLER SHELF GR/566
39	CRISPER COVER/566	714	CRISPER-CHILLER SHELF TOP/566
40	CRISP.COV.TRIM GR.FRONT/566	715	SEBZ. RAFI DEST.SACI/566
40A	R COMPARTMENT SHELF TRIM-RIGHT/566	716	CRISPER-CHILLER SHELF INSULATION/566
40B	R COMPARTMENT SHELF TRIM-LEFT/566	717	CRISPER-CHILLER SHELF BOTTOM/566
41	CRISPER/566	718	ACCESSORY FILM/CHILLER
70	SCREW KA 40*14 YSB-R-F-INOX	719	BOTTOM BASKET COVER/566
87	FRONT WHEEL GR.	720	BOTTOM BASKET GR./566
88	TOP HINGE COVER/HC	721	ACCESSORY FILM/FRZR BASKET
92	UPPER BASKET/566	722	BOTTOM BASK. GR/566
93	BOTTOM BASKET/566	723	UPPER BASKET COVER/566
321	CHIL. STOPPER	724	UPPER BASKET GR./566
332	CRISPER/566	725	UPPER BASK. GR/566
339	CHILLER SHELF GR/566	726	ICE RAIL RIGHT/566
341	CHIL.SHELF COV/466-566	727	ICE RAIL LEFT/566
423	SCREW KA 40*8 YSB-F-INOX	753	CHILLER RAIL OUT (RIGHT)/566
505	MIDDLE HINGE SREW CAP	754	CHILLER RAIL OUT (LEFT)/566

MARCH 2013



WHITE GOODS

NO-FROST COMBI 566 MECHANIC

MULTIFLOW PARTS

CUSTOMER SUPPORT

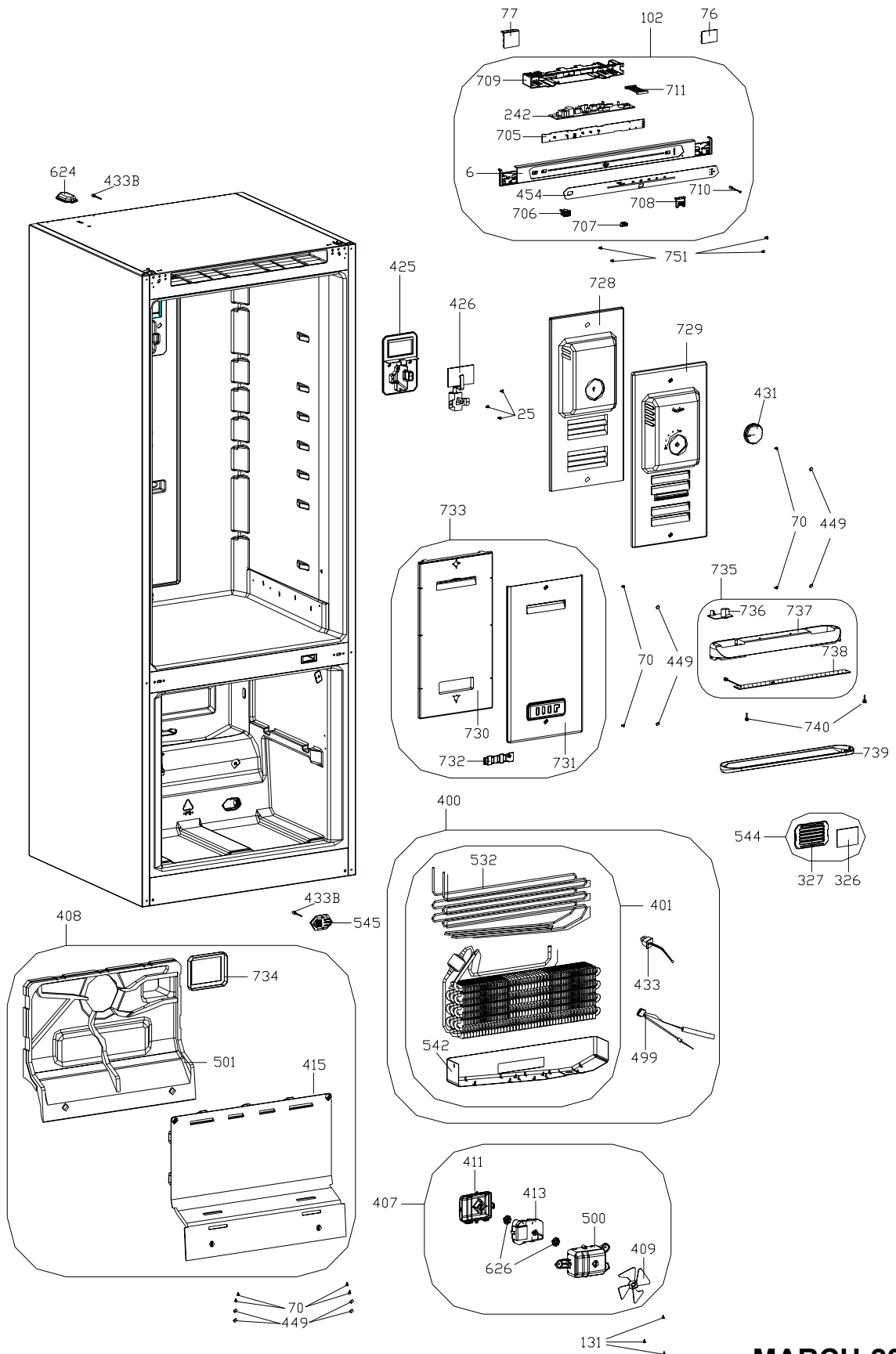

MARCH 2013



WHITE GOODS

NO-FROST COMBI 566 MECHANIC

MULTIFLOW PARTS LIST

**CUSTOMER
SUPPORT**

POSITION NUMBER	PART NAME	POSITION NUMBER	PART NAME
6	HEAD PANEL/566M-466M	501	F MULTI FLOW INSULATION/566
25	SCREW 40*13 YSB-R-C-INOX	532	FIN EVAP HEATER/566
70	SCREW KA 40*14 YSB-R-F-INOX	542	FIN EVAPORATOR CASE/566
76	HEAD PANEL COVER RIGHT/566	544	R AIRDUCKS COVER/566
77	HEAD PANEL COVER LEFT/566	545	SENSOR COVER/566
102	HEAD PANEL GR/566M	624	HOLDER-SENSOR
131	SCREW KA 40*14 YSB-C-INOX	626	FREEZER FAN MOTOR RUBBER
242	MAIN PCB/566M-466M	705	DISPLAY PCB/566M-466M
326	FILTER(GRANULLE'S)/566	706	ON/OFF SWITCH/466-566
327	R AIRDUCKS COVER/566	707	HEAD PANEL ON-OFF BUTTON/566
400	FIN EVAP.ASSY	708	HEAD PANEL MIDDLE BUTTON/566
401	FIN EVAPORATOR/566	709	MAIN BOARD BOX/566
407	F FAN MOTOR GR/566	710	NIGHT SENSOR
408	F MULTIFLOW GR/566	711	WIRE HARNESS/466-566
409	PROPELLER	728	R MULTI FLOW INSULATION GR/566M
411	F FAN MOTOR COVER/566	729	R MULTI FLOW TOP SRGF/566M
413	EVAP FAN MOTOR	730	R MULTI FLOW BOTTOM INSULATION/566
415	F MULTIFLOW COVER/566	731	R MULTI FLOW BOTTOM/566
425	DUMPER THERM.BOX/566	732	R MULTI FLOW VALVE/566
426	DUMPER THERMOSTAT	733	R MULTI FLOW BOTTOM GR/566
431	THERM.KNOB GR	734	FLOW GUIDE/566
433	DEFROST SENSOR/540	735	LED BOX ASSY/566
433B	AMBIENT SENSOR / ELECTROMECHANIC	736	POWER BOARD (LED STRIP)
449	R MULTIFLOW CAP	737	LED BOX/566
454	LEXAN SRGF/466M-566M	738	LED STRIP/466-566
455	SCREW KA 30*6 YSB-F	739	LED COVER/566
499	TERMAL FUSE	740	SCREW 22*50 SPECIAL4-F
500	F FAN MOTOR BOX/566	751	SCREW ST 4.2*12 SPECIAL11-C

MARCH 2013



WHITE GOODS

NO-FROST COMBI 566 MECHANIC

DOORASSY. PARTS

CUSTOMER
SUPPORT

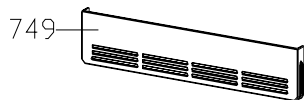
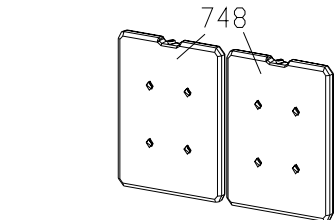
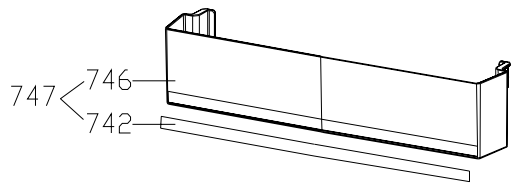
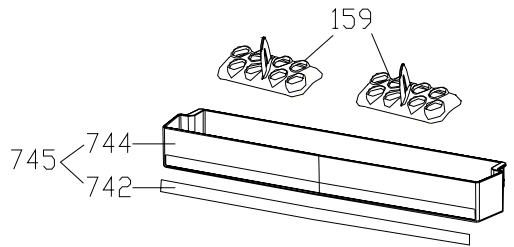
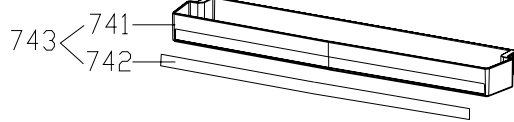
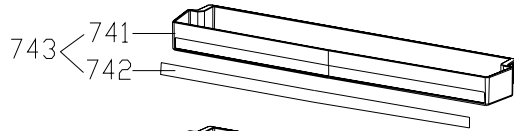

151

154

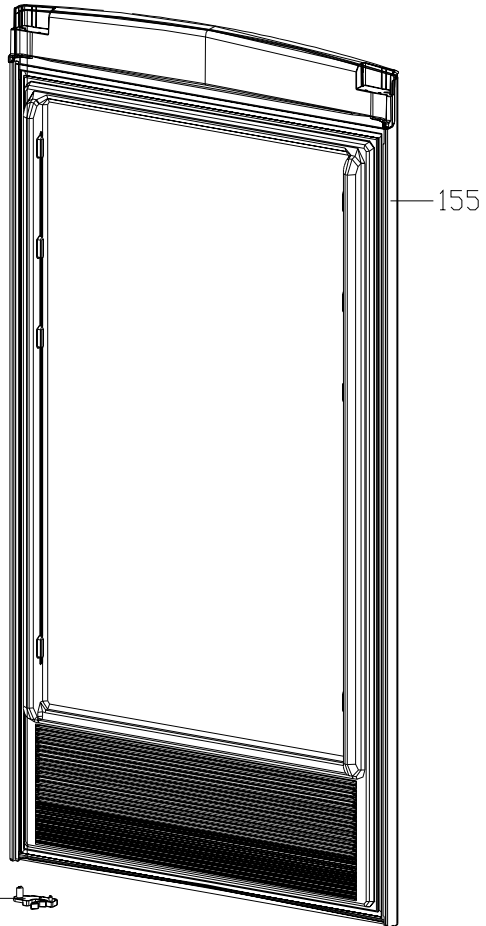

171

172

151

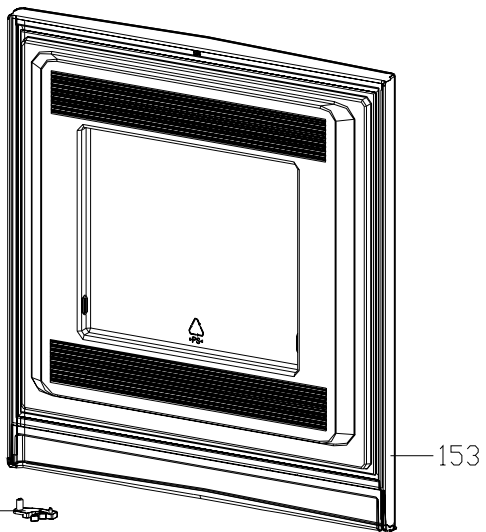

171

32

MARCH 2013



WHITE GOODS

NO-FROST COMBI 566 MECHANIC

DOOR ASSY. PARTS LIST

**CUSTOMER
SUPPORT**

POSITION NUMBER	PART NAME
32	SCREW KA 40*18 YSB-C-INOX
153	F DOOR ASSY/566SLINE
151	BUSHING/345P
154	LOGO
155	R DOOR ASSY/566M SLINE
159	EGG HOLDER
171	CATCHER RIGHT/CE-W
172	SCREW KA 35*12 YSB-C
741	EGG SHELF SMALL/566CUBE
742	ACCESSORY FILM/DOOR SHELF
743	EGG SHELF SMALL/566CUBE-W.FILM
744	EGG SHELF BIG/566CUBE
745	EGG SHELF BIG/566CUBE-W.FILM
746	BOTTLE SHELF/566CUBE
747	BOTTLE SHELF/566CUBE-W.FILM
748	COOLER ACU/391
749	COOLER ACU COVER SRGF/566

MARCH 2013



WHITE GOODS

NO-FROST COMBI 566 MECHANIC

COOLING SYSTEM PARTS

CUSTOMER
SUPPORT

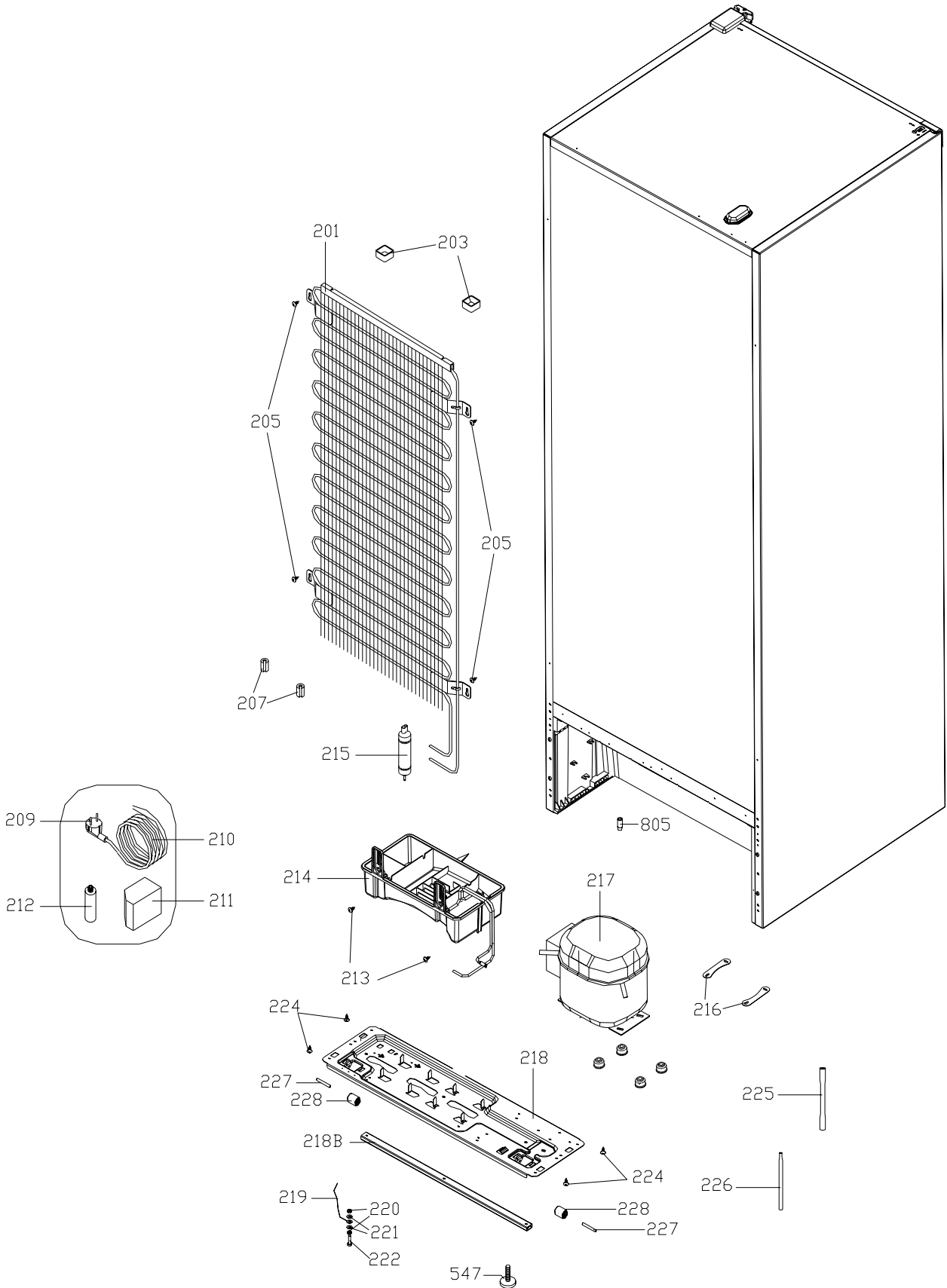

MARCH 2013



WHITE GOODS

NO-FROST COMBI 566 MECHANIC

COOLING SYSTEM PARTS LIST

**CUSTOMER
SUPPORT**

POSITION NUMBER	PART NAME
201	MAIN CONDENSER
203	SPACER
205	SCREW ST 4.8*13 YSB-T-C
207	ANTIVIBRATION (CONDANSER)
209	POWER CORD GROUP
210	POWER CORD
211	OVER LOAD RELAY
212	CAPACITOR
213	SCREW 4.2*9.5 YSB-C
214	EVAPORATING TRAY GR
215	DRYER
216	COMP FIXING BRACKET
217	COMPRESSOR
218	COMP BASEMENT
218B	COMP BASEMENT REINFORCEMENT/566
219	GROUNDLY WIRE/PGYB
220	NUT M4*3.2 DIN 934 ZNK
221	WASHER 4.3*8*0.9 DIN 6798 ZNK
222	SCREW M4*16 AKB-F
224	SCREW KA 50*14 YSB-F
225	SERVICE TUBE
226	DRYER VACUUM TUBE
227	FRONT/BACK WHEEL
228	REAR WHELL PIN
547	STATIONARY FOOT/BACK
805	WATER DRAIN TRAY DIAPHRAGM

MARCH 2013